

ELD2NM SLIDE ON LED

DESIGNED TO DISCREETLY BLEND IN
WITH YOUR GENERAL LIGHTING EVEN
WITH HIGH CEILING

ELD2NM



Slide on Module

Ordering Guide:

Ordering Code

ELD2NM-S

- Prevents damage to fluorescent or LED lamps as it is independent from voltage and output from the general lighting
- Reliability of the emergency modules is increased as the LED modules are addressed separately from the general lighting therefore aging effects are avoided.
- Easy wiring and full compatibility.
- Suitable for high ceiling and is applicable to areas which require higher illuminance levels than the existing IEC standards or Singapore Standards.

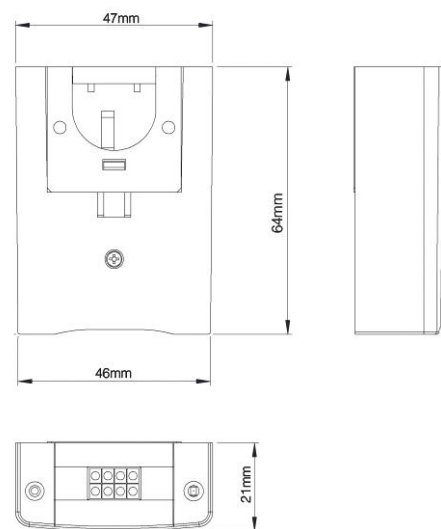
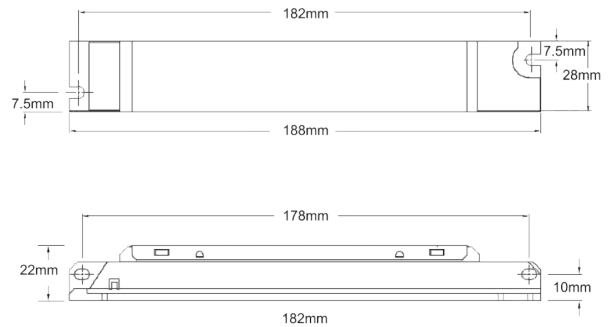

TECHNICAL SPECIFICATIONS

MODEL NO:	ELD2NM
Mode of Operation:	Non-Maintained
Lamp:	3 x 3W LED Modules
Rated Duration:	2 Hours
Mains Supply:	220-240 Volts, 50-60Hz
Power Consumption:	< 1.5W
Battery:	High Temperature Nickel Cadmium
Charge Monitor:	LED
Test Facility:	Micro switch
Safety Features:	Low battery voltage cut off to prevent over discharge
Fitting Construction:	Injection moulded with fire retardant, high impact material
Weight:	Approx. 0.3 Kg
Standards / Compliance:	SS IEC 60598-2-22



***Note: Technical Specification subject to change without prior notice